

# SPINNING REEL 7250RLA

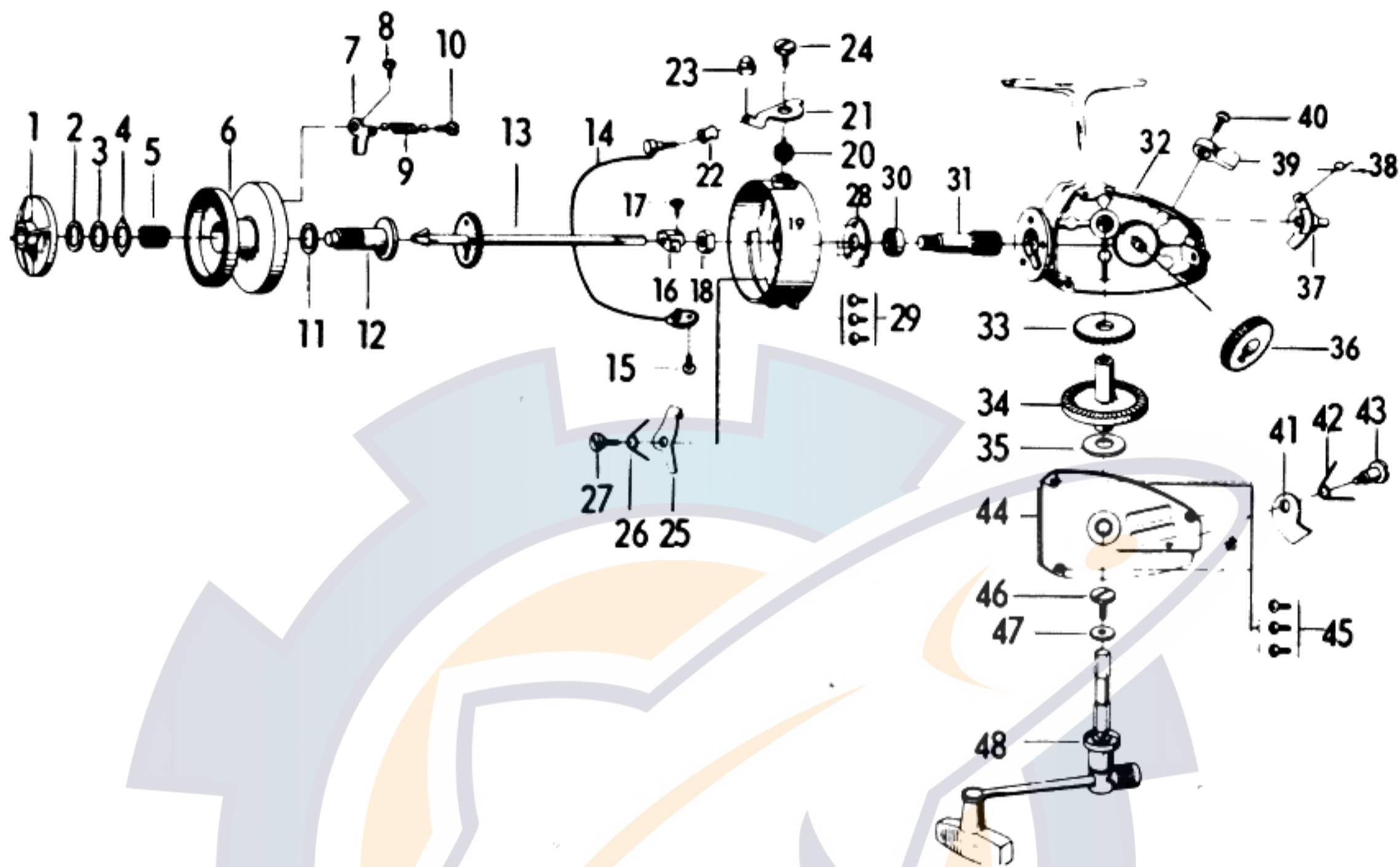

**LINE CAPACITY: 300 YDS., 6 LB. TEST**

| Key No. | Parts No.         | Parts Name              | Key No. | Parts No.          | Parts Name                          | Key No. | Parts No.         | Parts Name               |
|---------|-------------------|-------------------------|---------|--------------------|-------------------------------------|---------|-------------------|--------------------------|
| 1       | 440 9801 (4498)   | Drag-knob               | 17      | 351 0311 (35103a)  | Oscillating slider screw            | 33      | 400 6221 (4062)   | Oscillating pinion       |
| 2       | 371 4711 (37147)  | Disc washer             | 18      | 341 2801 (34128)   | Rotor nut                           | 34      | 411 8711 (A41187) | Driver gear              |
| 3       | 373 1501 (37315)  | Washer                  | 19      | 200 9521 (2095)    | Rotor                               | 35      | 370 5151 (3751a)  | Drive gear washer        |
| 4       | 373 1401 (37314)  | Washer                  | 20      | 141 0651 (14106)   | Bail spring                         | 36      | 000 1811 (A0018)  | Oscillating gear         |
| 5       | 141 8721 (14187)  | Spool ring              | 21      | 230 7311 (2373)    | Arm lever                           | 37      | 460 6821 (4668)   | Anti-reverse cam         |
| 6       | 511 9111 (51191)  | Spool                   | 22      | 250 1301 (2513)    | Line roller                         | 38      | 142 2801 (14228)  | Anti-reverse cam spring  |
| 7       | 040 1611 (0416)   | Click claw              | 23      | 341 2701 (34127)   | Bail nut                            | 39      | 540 3711 (5437)   | Anti-reverse lever       |
| 8       | 352 0601 (35206)  | Click claw screw        | 24      | 361 8511 (36185)   | Arm lever screw                     | 40      | 350 1931 (3519a)  | Anti-reverse lever screw |
| 9       | 142 0001 (14200)  | Click claw spring       | 25      | 570 5901 (5759)    | Bail kick lever                     | 41      | 110 7001 (1170)   | Anti-reverse claw        |
| 10      | 361 7401 (36174)  | Click claw spring screw | 26      | 142 2901 (14229)   | Bail kick lever spring              | 42      | 142 3001 (14230)  | Anti-reverse claw spring |
| 11      | 371 4901 (37149)  | Spool washer            | 27      | 361 8201 (36182)   | Bail kick lever screw               | 43      | 361 8311 (36183)  | Anti-reverse claw screw  |
| 12      | 005 2201 (A00522) | Spool shaft             | 28      | 633 5501 (63355)   | Ball bearing retaining washer       | 44      | 061 6701 (06167)  | Body cover               |
| 13      | 005 2121 (A00521) | Main shaft              | 29      | 350 1931 (3519a)   | Ball bearing retaining washer screw | 45      | 351 7801 (35178)  | Body cover screw         |
| 14      | 005 2011 (A00520) | Bail                    | 30      | 631 6901 (63169)   | Ball bearing                        | 46      | 351 5531 (35155)  | Handle screw             |
| 15      | 351 6601 (35166)  | Bail holder screw       | 31      | 401 2911 (40129)   | Pinion                              | 47      | 372 4601 (37246)  | Handle washer            |
| 16      | 480 5801 (4858)   | Oscillating slider      | 32      | 005 1921 (A00519a) | Body                                | 48      | 000 1721 (A0017)  | Handle                   |